

- GENERAL NOTES**
1. ALL DIMENSIONS ARE IN METRES UNLESS NOTED OTHERWISE
 2. ONLY WRITTEN DIMENSIONS SHALL BE USED. NO DIMENSIONS SHALL BE SCALED FROM THE DRAWINGS
 3. ALL LEVELS ARE IN METRES AND ARE TO MALIN HEAD DATUM
 4. ALL COORDINATES ARE IN METRES AND ARE TO IRISH TRANSVERSE MERCATOR
 5. DRAWINGS ARE TO BE READ IN CONJUNCTION WITH THE SPECIFICATION
 6. POSITIONS OF EXISTING UTILITIES ARE BASED ON RECORDS FROM UTILITY COMPANIES WHERE AVAILABLE. THESE ARE SHOWN FOR BACKGROUND INFORMATION ONLY.
 7. ALWAYS REFER TO UTILITY RECORDS PACK AND VERIFY POSITIONS OF ASSETS ON SITE PRIOR TO COMMENCING ANY EXCAVATIONS.

LEGEND:

- EXTENTS OF AREA REQUIRED FOR RESIDENTIAL CARPARK WITHIN THE UNUSED VOID AREA OF PHASE 2 BASEMENT
- 1.8m WIDE PEDESTRIAN WALKWAY WITHIN THE RESIDENTIAL CARPARK CIRCULATORY CARRIAGEWAY
- BOLLARDS TO DELINEATE RESIDENTIAL CARPARK
- COLLAPSIBLE BOLLARDS TO MANAGE RESIDENTIAL PARKING SPACE ACCESS
- M111, WHITE, 1200mm
- RRM 004, WHITE, 3600mm
- RRM 006, WHITE, 3600mm
- M 126, WHITE, 3600mm

LARGE CAR (2006)

OVERALL LENGTH	5.079m
OVERALL WIDTH	1.872m
OVERALL BODY HEIGHT	1.525m
MIN BODY GROUND CLEARANCE	0.310m
MAX TRACK WIDTH	1.831m
LOCK-TO-LOCK TIME	4.00s
CURB TO CURB TURNING RADIUS	5.900m

RESIDENTIAL CARPARK PLAN
181 No. Parking spaces

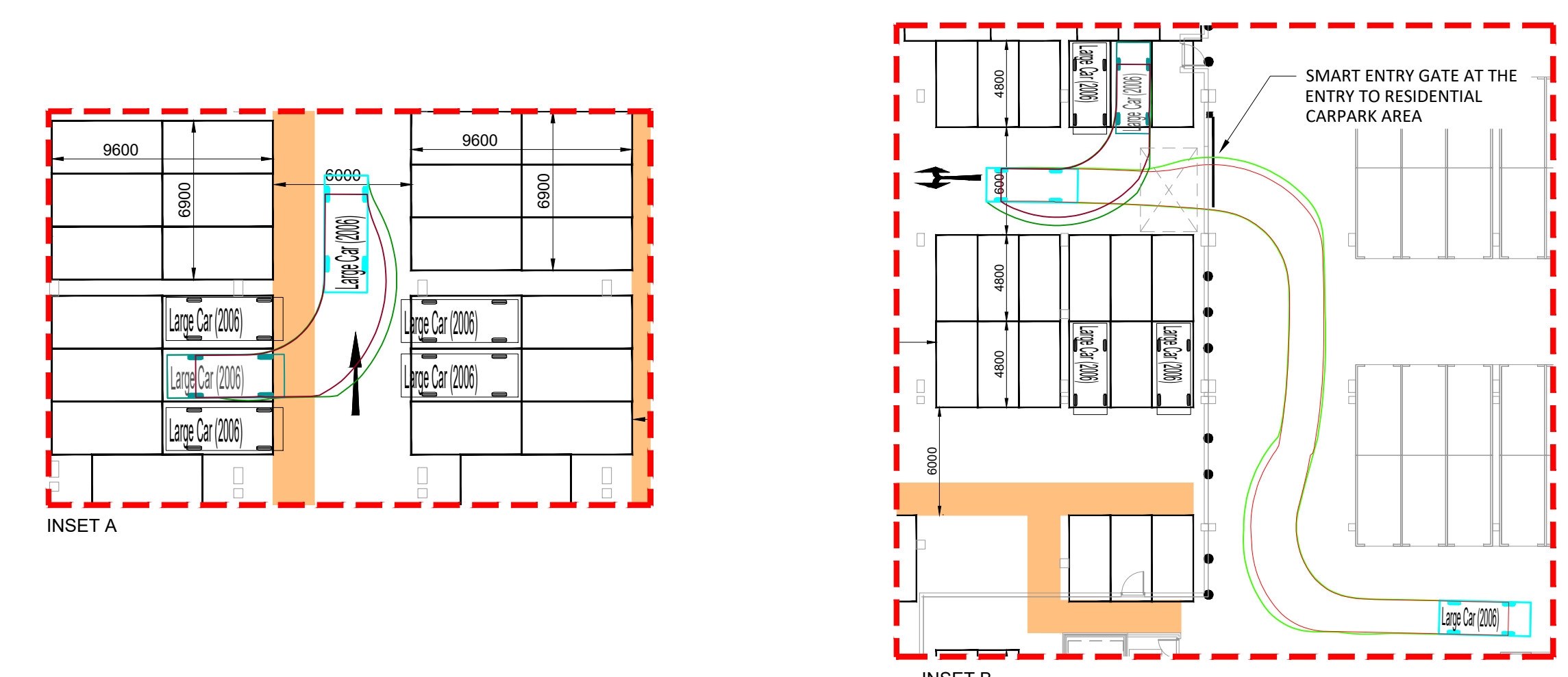

© ORDNANCE SURVEY IRELAND LICENSE No. AR 0082517.
ORDNANCE SURVEY IRELAND & GOVERNMENT OF IRELAND

File: 5168265_ATK_HT_0107.dwg
Date: Nov 14, 2019 - 1:37pm
Plotted by: KConvey

Rev	Description	By	Date	Chk'd	Auth
A	ISSUED FOR INFORMATION	YC	02.10.19	AN	KG
-	ISSUED FOR INFORMATION	RG	14.05.19	AN	KG

ATKINS
Member of the SNC-Lavalin Group

Atkins House, 150-155 Airside
Business Park, Swords, Co. Dublin
Tel (+353) 01 810 8000
Fax (+353) 01 810 8001

Unit 2B, 2200 Cork Airport
Business Park, Cork
Tel (+353) 021 429 0300
Fax (+353) 021 429 0360

2nd Floor Technology House
Parkmore Technology Park, Galway
Tel (+353) 091 786 0350
Fax (+353) 091 779 830

Client

Glenveagh Living

Project
KNOCKNACARRA DISTRICT CENTRE

Purpose
STAGE 3 SUBMISSION

Title
BASEMENT CARPARK CARPARK PLAN

Original Scale 1:200 at A1 1:400 at A3	Design/Drawn KH	Checked KG	Authorised
Status I	Date 09.04.19	Date 09.04.19	Date 17.04.19

Drawing Number
5168265 / ATK / HT / 0107

Rev
A